

WASTE MANAGEMENT

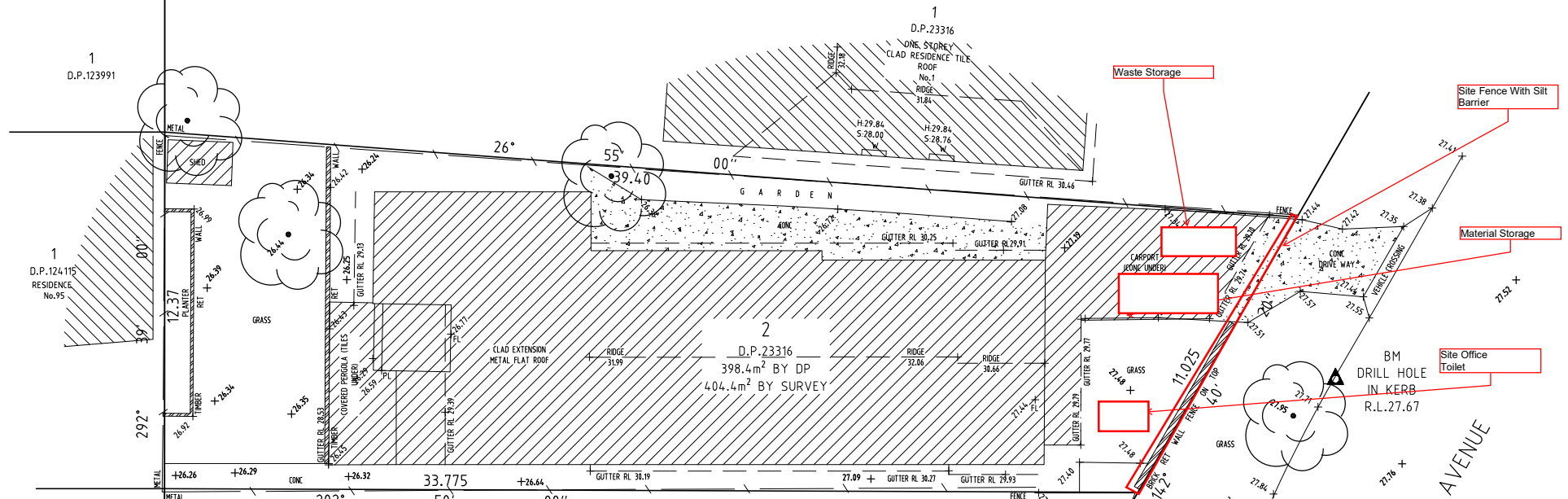

Soil and Water Management:

1. Install a silt fence as shown on plan prior to any on site earthworks commencing.
2. Install temporary sediment barriers to all inlet pits likely to collect silt-laden water until regrassed.
3. All silt fences and barriers are to be maintained in good construction and desilted during construction.

Construction Management:

1. Waste Materials are to be stockpiled or loaded into bins.

All protection works to be carried out in accordance with Sutherland Shire Council Environmental Site Management DCP

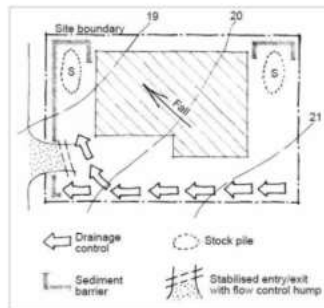

Sediment control layout on a compact urban site.

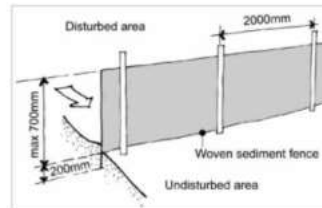

Woven sediment fences trap sediment but allow water through.

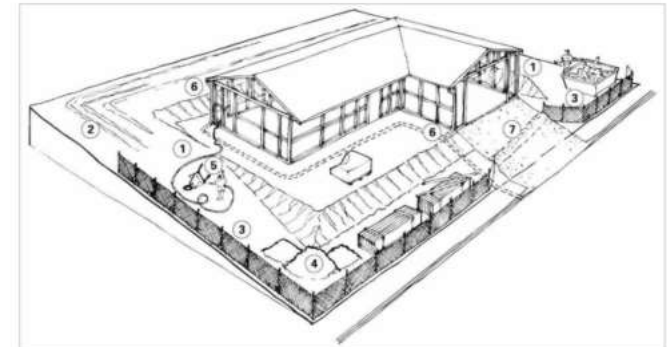

Erosion and sediment control measures: 1 minimise disturbance, 2 diversion devices, 3 sediment barriers, 4 secure stockpiles, 5 other containments, 6 early stormwater connection, 7 controlled access point.